

「變更中部科學工業園區台中基地附近特定區計畫(部分農業區為公園用地、公墓用地)案」樁位成果圖

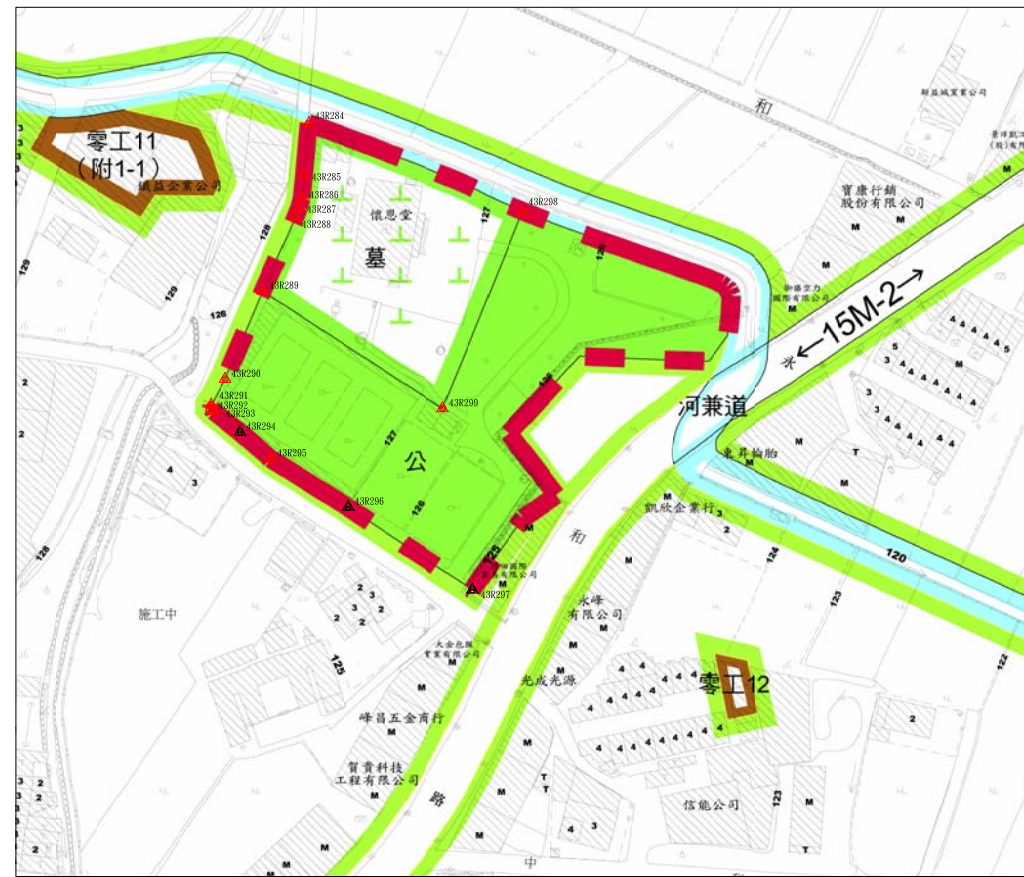

都市計畫樁位公告圖 SCALE=1/1000

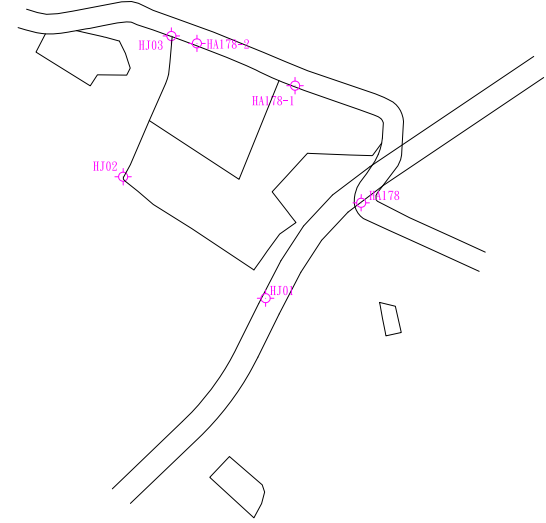

控制測量成果 SCALE=1/2000

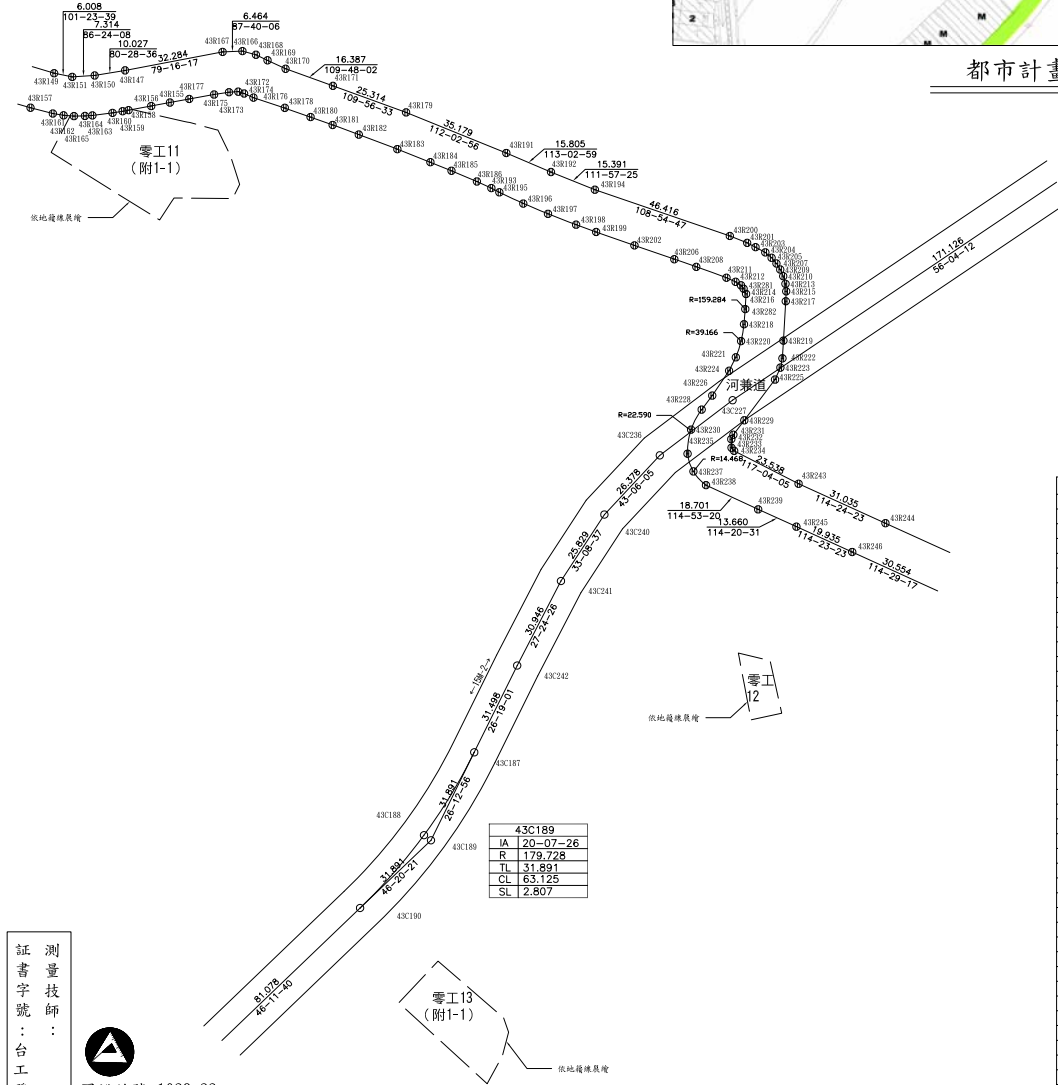

樁位坐標成果表

| 點號 | 縱坐標 | 橫坐標 | 備註 |
|--------|-------------|------------|----------|
| 43R180 | 2678663.701 | 212493.380 | 恢復樁位 |
| 43R181 | 2678661.120 | 212500.547 | 恢復樁位 |
| 43R182 | 2678658.001 | 212509.068 | 廢樁 |
| 43R183 | 2678653.249 | 212521.616 | 恢復樁位 |
| 43R184 | 2678649.010 | 212532.366 | 廢樁 |
| 43R185 | 2678646.230 | 212539.221 | 恢復樁位 |
| 43R186 | 2678642.744 | 212547.501 | 廢樁 |
| 43R193 | 2678640.579 | 212552.200 | 恢復樁位 |
| 43R195 | 2678639.212 | 212554.802 | 廢樁 |
| 43R196 | 2678635.560 | 212562.578 | 恢復樁位 |
| 43R197 | 2678632.220 | 212570.628 | 恢復樁位 |
| 43R198 | 2678628.701 | 212579.761 | 恢復樁位 |
| 43R199 | 2678626.327 | 212586.290 | 廢樁 |
| 43R202 | 2678621.944 | 212598.752 | 恢復樁位 |
| 43R206 | 2678617.450 | 212611.721 | 廢樁 |
| 43R208 | 2678614.971 | 212618.871 | 恢復樁位 |
| 43R211 | 2678611.445 | 212628.693 | 恢復樁位 |
| 43R212 | 2678610.107 | 212631.663 | 廢樁 |
| 43R214 | 2678608.973 | 212633.408 | 廢樁 |
| 43R216 | 2678606.163 | 212635.071 | 廢樁 |
| 43R218 | 2678596.303 | 212634.403 | 廢樁 |
| 43R220 | 2678590.830 | 212633.455 | 廢樁 |
| 43R221 | 2678585.547 | 212631.742 | 廢樁 |
| 43R224 | 2678581.175 | 212629.536 | 廢樁 |
| 43R226 | 2678573.110 | 212624.052 | 廢樁 |
| 43R228 | 2678568.549 | 212620.624 | 廢樁 |
| 43R281 | 2678607.854 | 212634.273 | 廢樁 |
| 43R282 | 2678601.228 | 212634.814 | 廢樁 |
| 43R284 | 2678602.175 | 212497.639 | 新建樁位 |
| 43R285 | 2678645.431 | 212496.153 | 新建樁位 |
| 43R286 | 2678637.830 | 212495.310 | 新建樁位 |
| 43R287 | 2678634.829 | 212494.533 | 新建樁位 |
| 43R288 | 2678631.664 | 212493.333 | 新建樁位 |
| 43R289 | 2678607.645 | 212482.691 | 新建樁位 |
| 43R290 | 2678578.981 | 212470.384 | 新建樁位 |
| 43R291 | 2678570.617 | 212465.869 | 新建樁位 |
| 43R292 | 2678569.677 | 212465.820 | 新建樁位 |
| 43R293 | 2678568.611 | 212466.622 | 新建樁位 |
| 43R294 | 2678561.780 | 212475.258 | 新建樁位(廢樁) |
| 43R295 | 2678553.118 | 212465.297 | 新建樁位 |
| 43R296 | 2678537.419 | 212470.431 | 新建樁位(廢樁) |
| 43R297 | 2678510.466 | 212550.829 | 新建樁位(廢樁) |
| 43R298 | 2678633.626 | 212567.188 | 新建樁位 |
| 43R299 | 2678569.451 | 212541.128 | 新建樁位 |

| 樁號 | 樁號 | 角度 | 距離 |
|--------|--------|-----------|--------|
| 43R166 | 43R168 | 104-58-56 | 4.568 |
| 43R168 | 43R169 | 115-43-48 | 4.174 |
| 43R169 | 43R170 | 115-11-05 | 6.479 |
| 43R200 | 43R201 | 111-38-04 | 6.057 |
| 43R201 | 43R203 | 117-05-57 | 3.071 |
| 43R203 | 43R204 | 118-16-38 | 3.607 |
| 43R204 | 43R205 | 130-39-49 | 2.893 |
| 43R205 | 43R207 | 139-31-09 | 2.423 |
| 43R207 | 43R209 | 147-50-17 | 2.329 |
| 43R209 | 43R210 | 155-52-16 | 2.378 |
| 43R210 | 43R213 | 163-38-50 | 2.999 |
| 43R213 | 43R215 | 174-19-53 | 2.440 |
| 43R217 | 43R215 | 2-27-12 | 3.224 |
| 43R219 | 43R217 | 3-24-56 | 12.841 |
| 43R222 | 43R219 | 3-15-49 | 5.761 |
| 43R223 | 43R222 | 12-25-34 | 3.090 |
| 43R225 | 43R223 | 24-04-08 | 4.282 |
| 43R229 | 43R225 | 37-03-03 | 16.587 |
| 43R231 | 43R229 | 37-03-14 | 5.918 |
| 43R232 | 43R231 | 25-32-34 | 1.579 |
| 43R232 | 43R233 | 178-39-49 | 2.787 |
| 43R233 | 43R234 | 138-57-20 | 1.333 |
| 43R127 | 43R161 | 104-37-49 | 7.511 |
| 43R161 | 43R162 | 99-32-52 | 3.533 |
| 43R162 | 43R165 | 94-11-47 | 3.389 |
| 43R165 | 43R164 | 89-10-45 | 3.560 |
| 43R164 | 43R163 | 85-56-34 | 2.445 |
| 43R163 | 43R160 | 82-49-04 | 6.599 |
| 43R160 | 43R159 | 80-37-11 | 3.332 |
| 43R159 | 43R158 | 80-04-00 | 1.959 |
| 43R158 | 43R156 | 79-38-45 | 7.500 |
| 43R156 | 43R155 | 79-28-02 | 6.204 |
| 43R155 | 43R177 | 79-31-20 | 6.373 |
| 43R177 | 43R175 | 79-50-55 | 8.216 |
| 43R175 | 43R173 | 81-07-28 | 4.913 |
| 43R173 | 43R172 | 86-39-34 | 3.003 |
| 43R172 | 43R174 | 107-07-48 | 2.013 |
| 43R174 | 43R176 | 113-47-13 | 3.312 |
| 43R176 | 43R178 | 108-05-44 | 10.731 |
| 43R178 | 43R180 | 109-37-48 | 8.900 |
| 43R180 | 43R284 | 109-42-50 | 4.524 |
| 43R284 | 43R181 | 109-56-19 | 3.093 |
| 43R181 | 43R182 | 110-06-16 | 9.074 |
| 43R182 | 43R183 | 110-44-31 | 13.418 |
| 43R183 | 43R184 | 111-31-14 | 11.556 |
| 43R184 | 43R185 | 112-04-29 | 7.397 |

| 樁號 | 樁號 | 角度 | 距離 |
|--------|--------|-----------|--------|
| 43R185 | 43R186 | 112-49-54 | 8.984 |
| 43R186 | 43R183 | 114-44-14 | 5.174 |
| 43R183 | 43R185 | 117-42-57 | 2.939 |
| 43R185 | 43R196 | 115-09-26 | 8.591 |
| 43R196 | 43R298 | 112-45-33 | 4.999 |
| 43R298 | 43R187 | 112-13-52 | 3.716 |
| 43R187 | 43R198 | 111-04-19 | 9.787 |
| 43R198 | 43R199 | 109-58-54 | 6.947 |
| 43R199 | 43R202 | 109-22-38 | 13.210 |
| 43R202 | 43R206 | 109-06-44 | 13.726 |
| 43R206 | 43R208 | 109-07-20 | 7.568 |
| 43R208 | 43R211 | 109-45-58 | 10.426 |
| 43R211 | 43R212 | 114-10-47 | 3.267 |
| 43R212 | 43R214 | 123-01-05 | 2.081 |
| 43R214 | 43R281 | 142-16-26 | 1.414 |
| 43R281 | 43R216 | 154-44-48 | 1.870 |
| 43R216 | 43R221 | 26-46-28 | 4.897 |
| 43R221 | 43R224 | 34-12-36 | 9.752 |
| 43R224 | 43R226 | 36-56-10 | 5.706 |

圖例

| 符號 | 說明 |
|----|----------|
| ○ | 道路中心樁 |
| ○ | 樁位 |
| ○ | 副樁 |
| ○ | 廢樁 |
| ○ | 新建樁位 |
| ○ | 新建樁位(廢樁) |
| ○ | 恢復樁位(廢樁) |
| ○ | 恢復樁位 |
| ○ | 檢測樁位 |

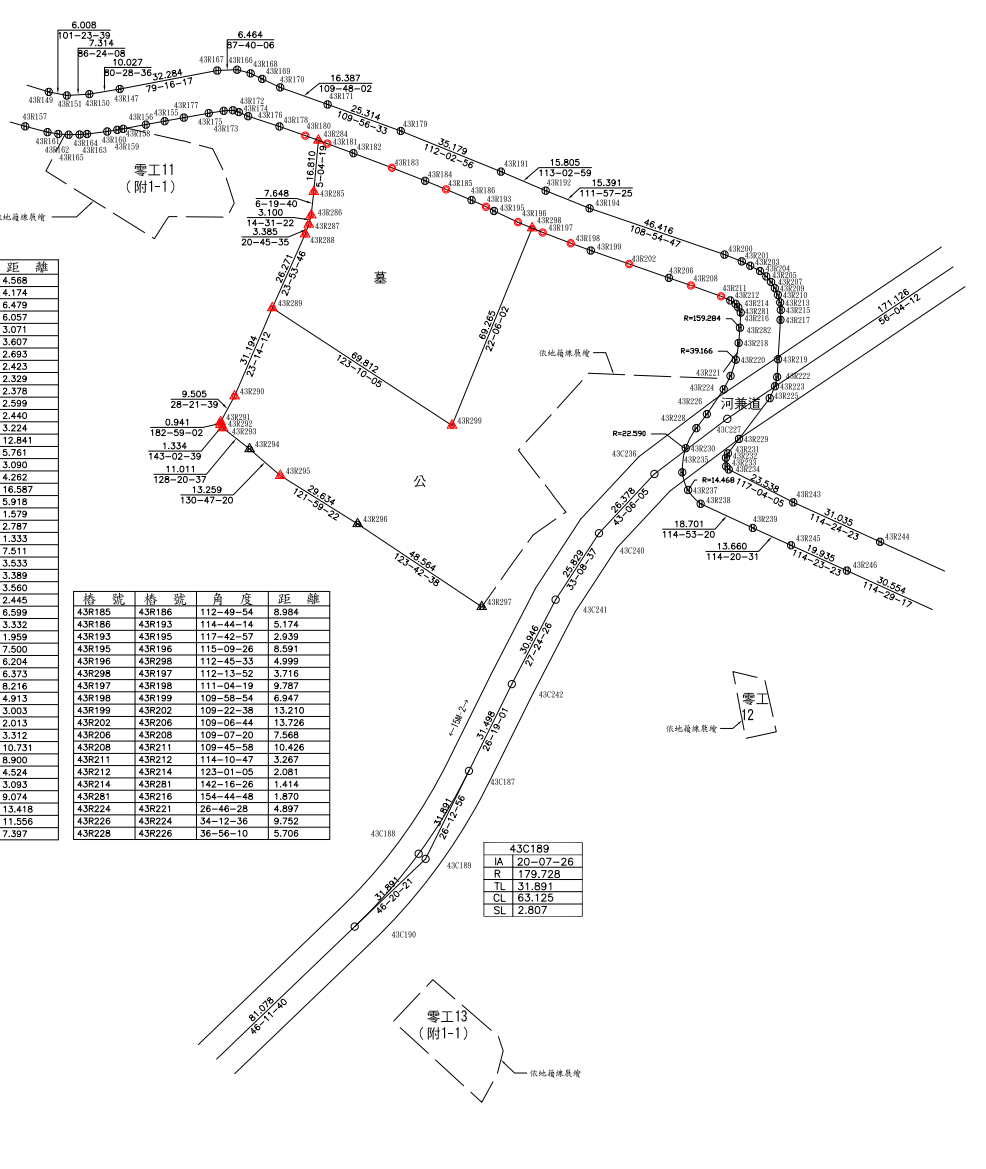

變更後都市計畫樁位圖 SCALE=1/1000

變更前都市計畫樁位圖 SCALE=1/1000

測量技師：
證書字號：台工登字第8558號

圖說編號：1028-22
測量時間：109年06月
測量人員：黃志忠
負責人：江俊淑
測量單位：亞興測量有限公司
公司地址：臺中市西區臺灣大道二段101號13樓